

# Installation Guide

## REAR FRAME INSERTS

Z5259

### PAGE 1

(Always refer to the current catalogue for complete application listings)

#### Component List:

- 🔩 67722 - Rear Upper Insert - Quantity x 2
- 🔩 67724 - Front Upper Insert - Quantity x 2
- 🔩 67725 - Front & Rear Lower Insert - Quantity x 2
- 🔩 NG-8 - Grease - Quantity x 2

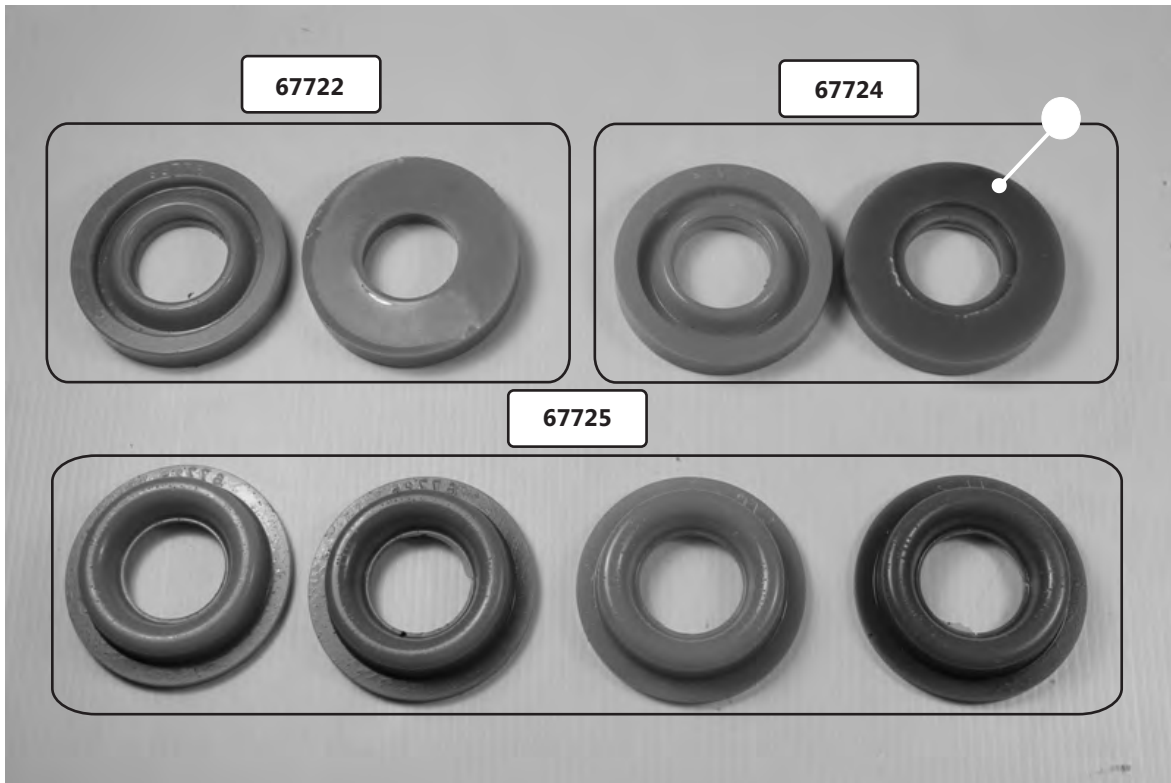

#### 🔩 Outcome:

The supplied kit is designed to be easily installed and reduce the amount of associated rear frame movement during high loading vehicle manoeuvres whilst maintaining a high degree of cabin comfort from eliminating excessive cabin noise associated with full frame bushing installation.

The insert kit is designed to fill the OEM rubber voiding cavity and restrict movement of the frame and also aid in providing longevity to the rubber OEM frame bushings by aiding in the load carrying capability of the bushing.

**Note:** Inserts 67722 & 67724 are similar in design(see image attached) and may be confused with one another. Please make sure the step is noted in bushing 67724 before installation to eliminate any failure of the inserts from incorrect installation. 67724 bushing step in the top face is designed to locate into the OEM washer fitted.

Please ensure all bolts are re-torqued after fitment of the inserts and are re-checked after a settling in period of 100 Km's or 62 Miles.

# Installation Guide

## REAR FRAME INSERTS

Z5259

### PAGE 2

*(Always refer to the current catalogue for complete application listings)*

**N.B:** This installation guide should be used in conjunction with the workshop manual.

#### **FIGURE 1**

☞ Support rear of frame using a suitable stand or jack.



#### **FIGURE 2**

☞ Completely remove the right rear frame retaining bolt from the frame. Ensure the frame is fully supported by the stand or jack.

**Note: Do Not remove the bolts without the frame supported.**

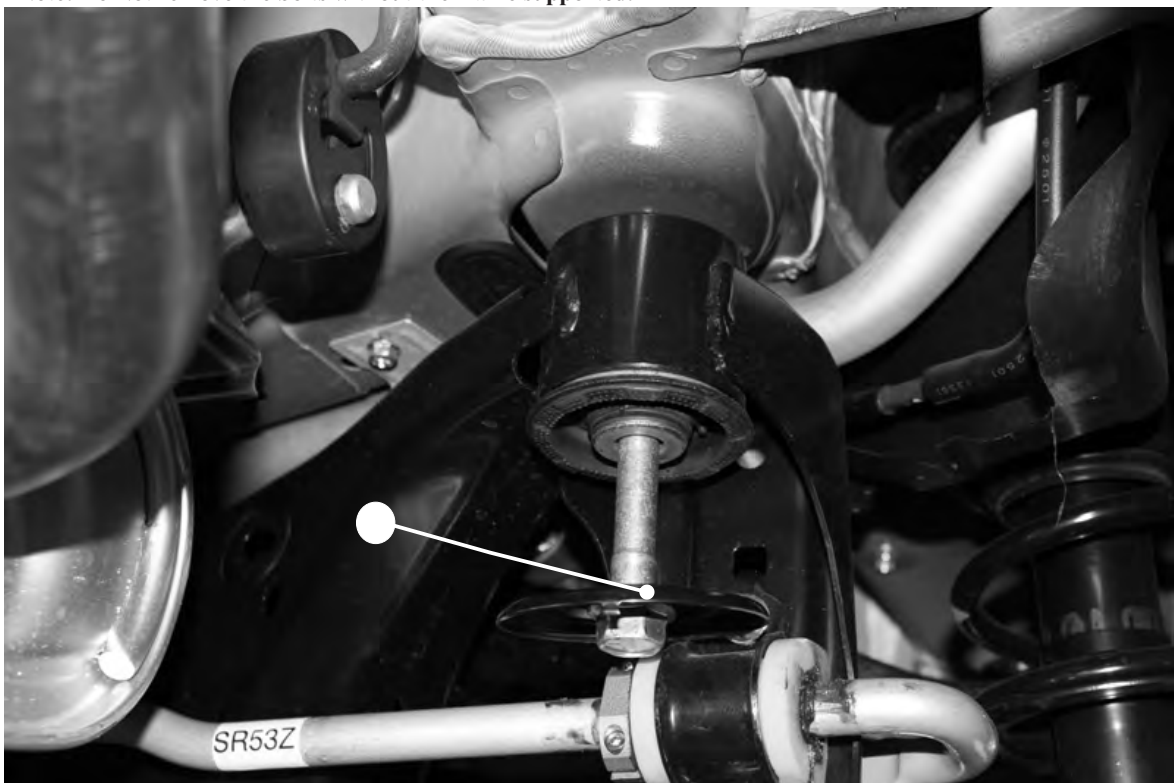

# Installation Guide

## REAR FRAME INSERTS

### PAGE 3

Z5259

**FIGURE 3**

✍️ Completely remove the Left hand rear frame retaining bolt.



**FIGURE 4**

Apply supplied grease to the face of the bushings and insert the supplied 67722 insert onto the top of the frame on both sides.

**Note:** Part number can be located on the outside face of the inserts.



# Installation Guide

## REAR FRAME INSERTS

### PAGE 4

Z5259

**FIGURE 5**

✍ Install Supplied 67725 inserts to the lower frame bushings ensuring adequate greasing of insert faces.



**FIGURE 6**

✍ Re-fit the OEM washer and bolt and hand tighten sufficiently to support weight of the frame.

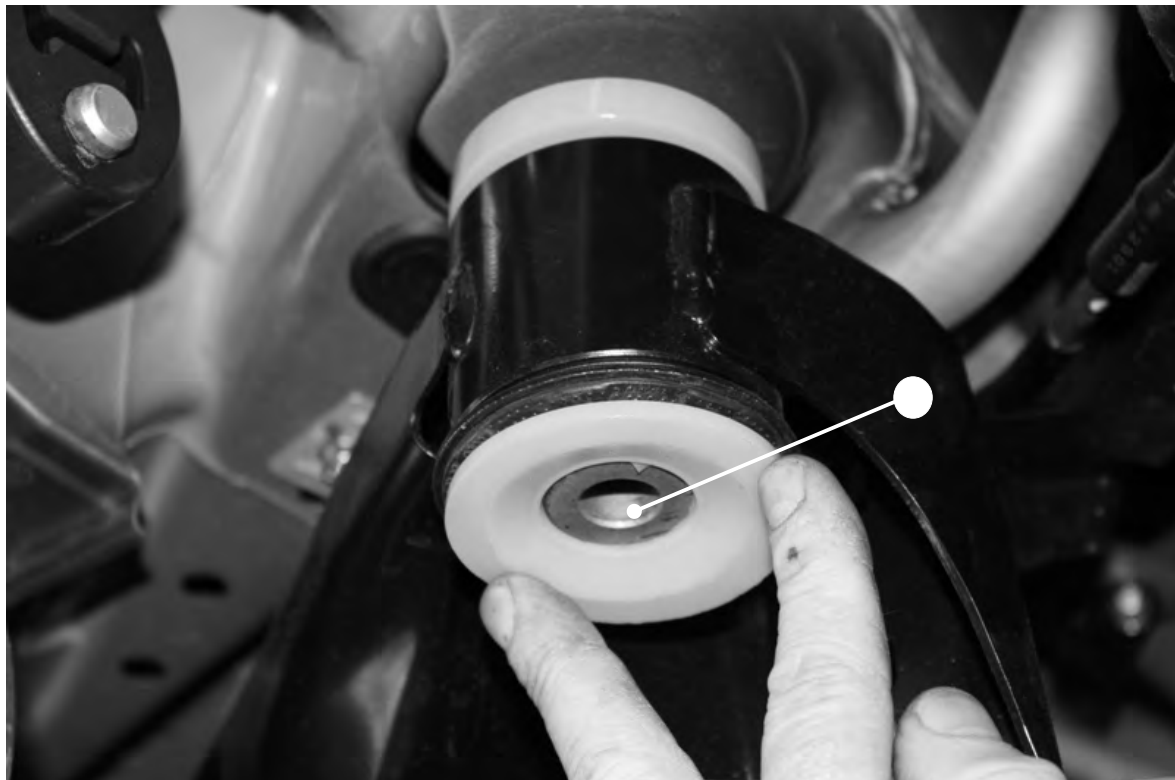

# Installation Guide

## REAR FRAME INSERTS

### PAGE 5

Z5259

**FIGURE 7**

Support the front of the frame and remove the bolts indicated below. Once removed place the brackets aside and lower the frame enough to gain access to the steel OEM washer on the top of the OEM bushing.

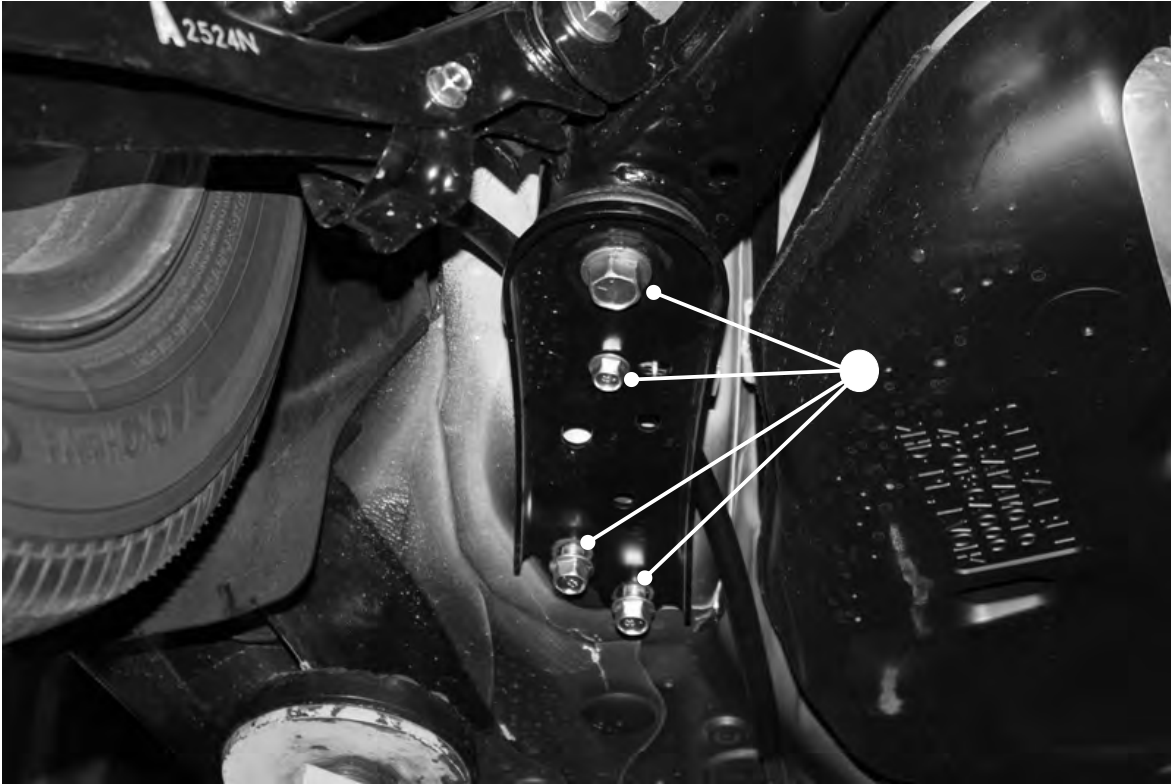

**FIGURE 8**

Locate the bushing 67724 and grease both faces of the bushing. Install the insert into the OEM rubber bushing.

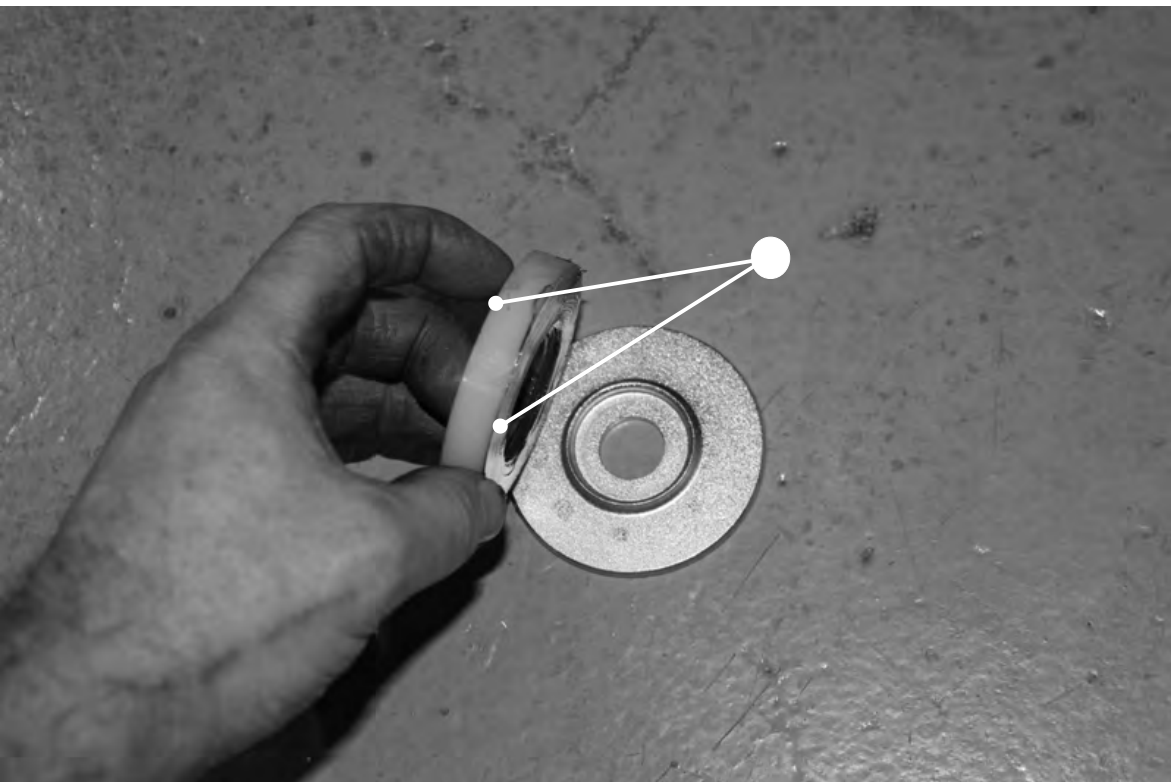

# Installation Guide

## REAR FRAME INSERTS

### PAGE 6

Z5259

#### **FIGURE 9**

Locate insert 67725 & grease both faces of the bushing and re-install the brackets and bolts. Tighten all bolts front and rear.

**Note:** Bushings are designed to be of interference fit so some level of crush will be noted during installation.

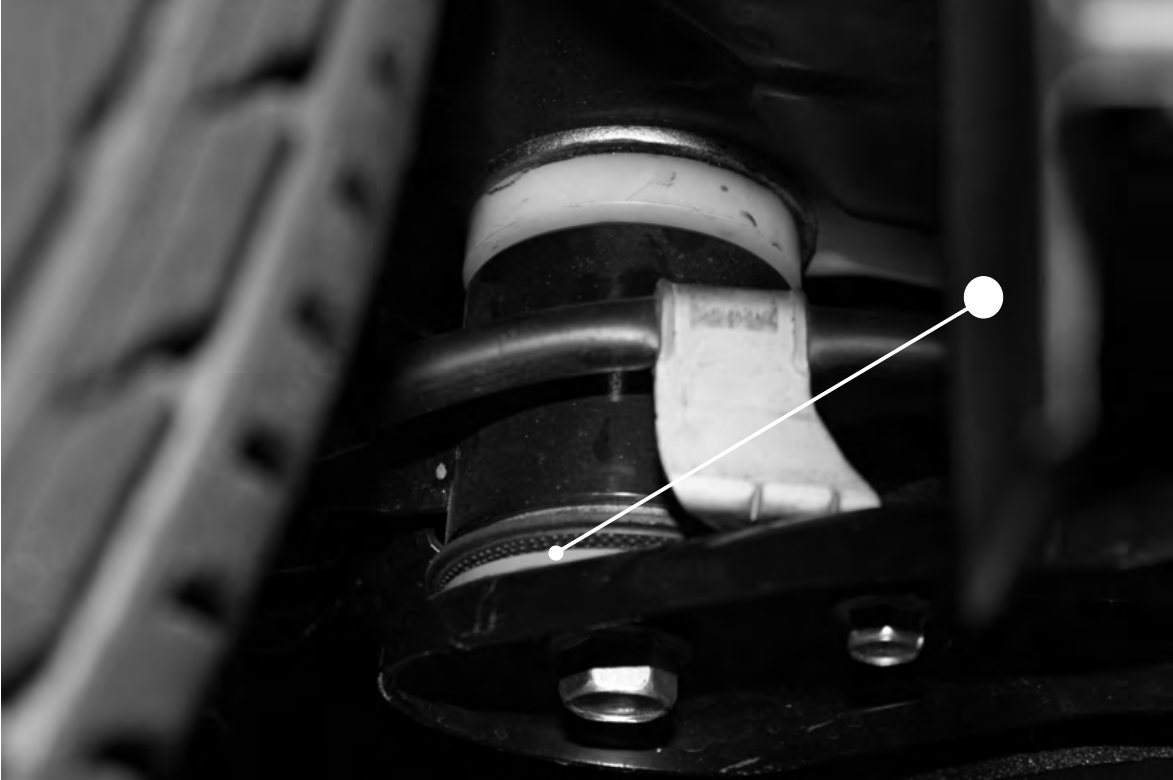

#### **FIGURE 10**

*✍* Torque all bolts to manufacturers specifications or alternatively use the torque guide provided within this installation procedure.

