

General instructions for Control Arm - Track Arm - Rod Eye

N.B: This instruction sheet should be used in conjunction with the workshop manual

Please read instructions carefully. Improper installation may result in premature failure.

If required, vehicle should be jacked up evenly and safely supported.

Ensure all components are free from rust, scale and dirt

IMPORTANT: The original shell may or may not have to be removed. Compare diameter sizing.

1-piece bushings are best pressed in with soapy water and flat surface.

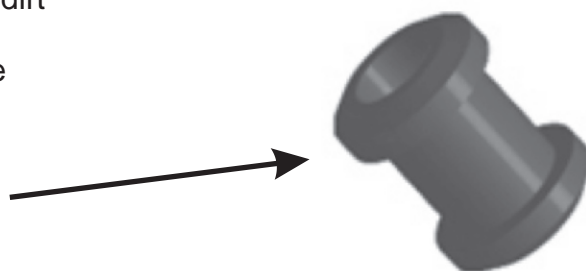

Compare new supplied components to old parts for correct application.

Be careful when working near hot components, such as exhaust systems.

Control arms and Track Arms with a pivoting bushing do require greasing - apply a generous coating of supplied grease to bushing ID and side faces. Do not grease bushing OD.

It is recommended all components be tightened when vehicle is at ride-height.

It is recommended to carry out a Wheel Alignment post install.

It is recommended re-checking all hardware after initial 100kms travelled.

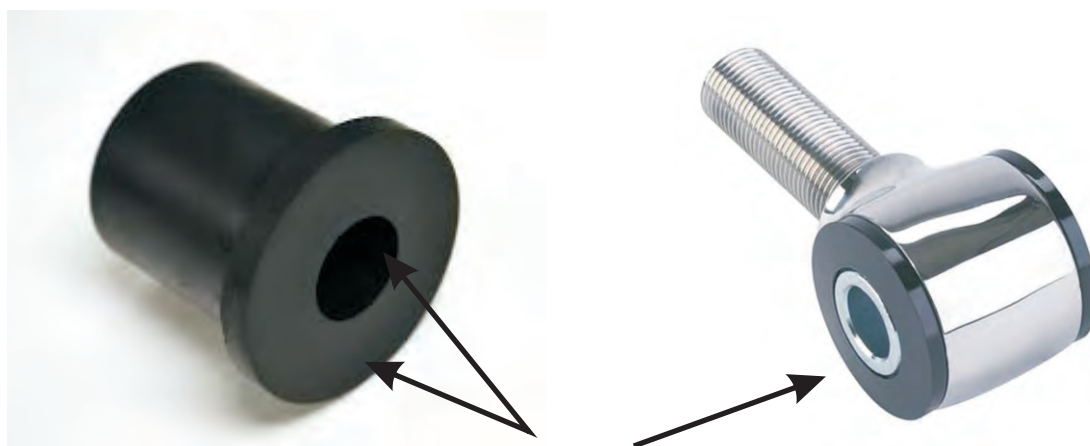

Grease bushing side face and ID with supplied grease only.

N.B: It is recommended that a licenced workshop or tradesperson carry out the above procedure and that workshop manual and relevant safety procedures are followed in addition to the above.